

STANDARD PUMP OUT DESIGN NOTES

The pump out system shall be designed to be operated in the following manner:-

- The pumps shall be programmed to work alternately so as to allow both pumps to have an equal operation load and pump life.
- A low level float shall be provided to ensure that the minimum required water level is maintained within the sump area of the below ground tank. In this regard this float will function as an off switch for the pumps.
- A second float shall be provided at a higher level, approximately 300mm above the minimum water level, whereby one of the pumps will operate and drain the tank to the level of the low-level float.
- A third float shall be provided at a high level, which is approximately the roof level of the below ground tank. This float should start the other pump that is not operating and activate the alarm.
- An alarm system shall be provided with a flashing strobe light and a pump failure warning sign which are to be located at the driveway entrance to the basement level. The alarm system shall be provided with a battery back-up in case of power failure.



CONFINED SPACE DANGER SIGN

COLOURS - 'DANGER' AND BACKGROUND	- WHITE
ELLIPTICAL AREA	- RED
RECTANGLE CONTAINING ELLIPSE	- BLACK
OTHER LETTERING AND BORDER	- BLACK

- A) A CONFINED SPACE DANGER SIGN SHALL BE POSITIONED IN A LOCATION AT ALL ACCESS POINTS, SUCH THAT IT IS CLEARLY VISIBLE TO PERSONS PROPOSING TO ENTER THE BELOW GROUND TANK/S CONFINED SPACE.
- B) MINIMUM DIMENSIONS OF THE SIGN - 300mm x 450mm (LARGE ENTRIES, SUCH AS DOORS)
- 250mm x 180mm (SMALL ENTRIES SUCH AS GRATES & MANHOLES)
- C) THE SIGN SHALL BE MANUFACTURED FROM COLOUR BONDED ALUMINIUM OR POLYPROPYLENE.
- D) SIGN SHALL BE AFFIXED USING SCREWS AT EACH CORNER OF THE SIGN.

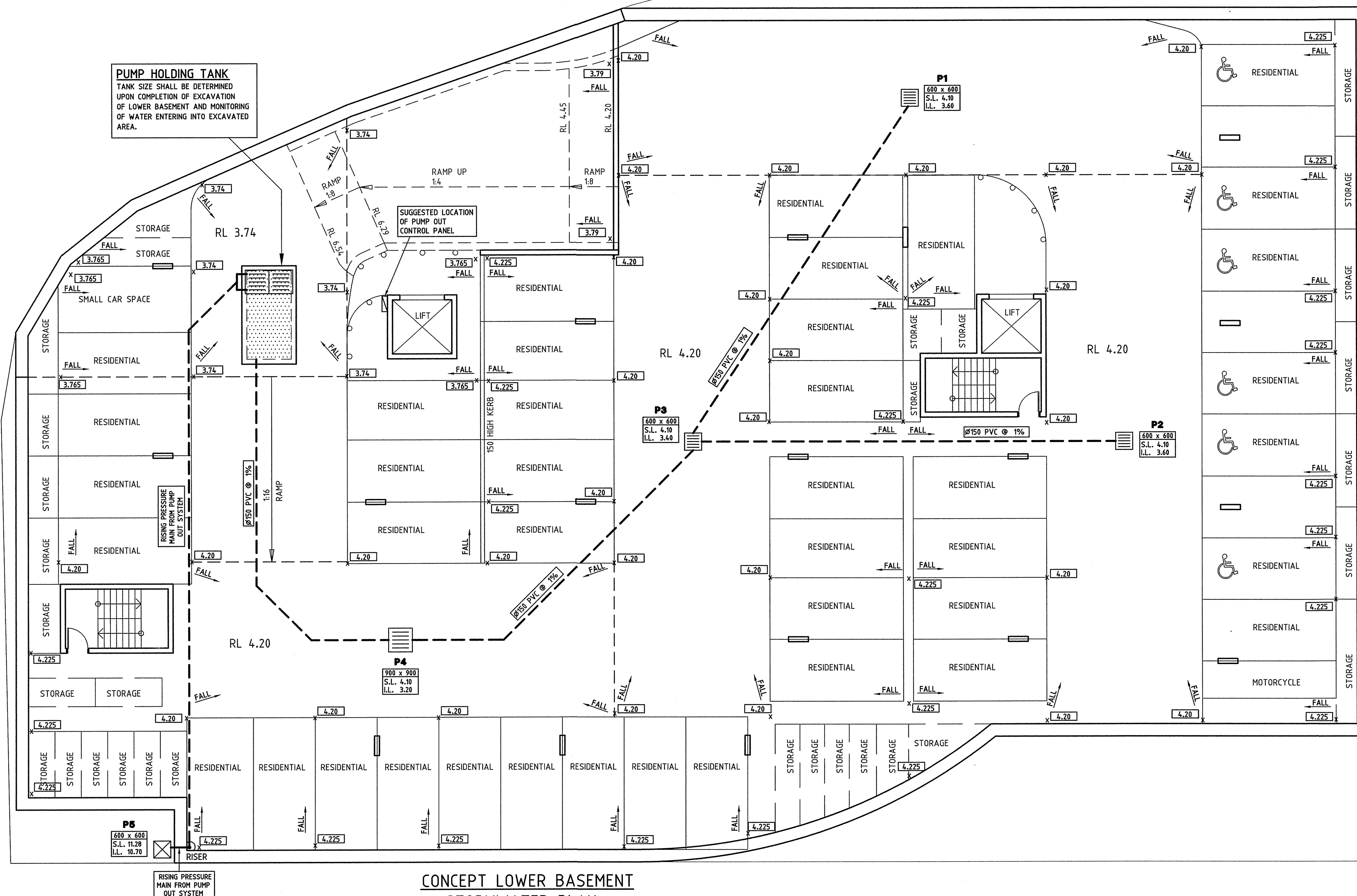

CONCEPT LOWER BASEMENT
STORMWATER PLAN
SCALE 1:100

				© Copyright Manice Araj Engineering Pty. Ltd. as at date of issue.		FOR COUNCIL / CONSTRUCTION CERTIFICATE ISSUE		 HKMA ENGINEERS CONSULTING CIVIL & STRUCTURAL ENGINEERS 241-245 PENNANT HILLS ROAD, CARLINGFORD PH. 9687 9222 FAX. 9687 9393				PROJECT PROPOSED MIXED USE DEVELOPMENT 5 PARKES STREET PARRAMATTA		DRAWING TITLE CONCEPT LOWER BASEMENT STORMWATER DRAINAGE DRAWING		DESIGNED CE CHECKED SA DATUM AHD SCALE 1:100		DRAWING NUMBER 6273-C DA04		ISSUE B A1		SHEET 4 OF 4	
B	AMENDED TO SUIT ARCHITECTURAL CHANGES	CE	01/11/11	HKMA ENGINEERS (A DIVISION OF MANICE ARAJ ENGINEERING PTY LTD) IS THE OWNER OF THE COPYRIGHT SUBSISTING IN THESE DRAWINGS AND ALL RELATED DESIGNS AND SPECIFICATIONS. THESE DRAWINGS AND ANY RELATED DESIGNS AND SPECIFICATIONS MUST NOT BE REPRODUCED OR USED IN WHOLE OR IN PART NOR MAY THE IDEAS CONCEPTS OR INFORMATION CONTAINED IN THESE DRAWINGS AND RELATED DESIGNS AND SPECIFICATIONS BE USED IN ANY WAY WHATSOEVER EXCEPT IN ACCORDANCE WITH THE AGREEMENT BETWEEN HKMA ENGINEERS AND THE CLIENT.		CHECKED BY Signature:  Date: 1/11/11 STEVE ARR AJ B.Eng.(Civil)																	
A	ISSUE FOR DEVELOPMENT APPLICATION	CE	26/07/11																				
ISSUE	DESCRIPTION	BY	DATE																				